

Frederick Co, Maryland

Equity ES-3, 478-479

#2589 – Dec 1854

Estate of Joshua BARNES

The following plat was filed Decr. 14th 1854.

Part of a tract of land called "The Resurvey on Smith's Lot" originally on the 30th day of August 1810. Conveyed by Gabriel Markel, to John Kusbaum, for $46\frac{1}{4}$ acres & 21 square perches of Land - part of a Tract called "Father's Gift" originally on the 22^d day of April 1799. Conveyed by Adam Markel to John Kusbaum for 100 acres. - and part of a tract called "The Resurvey on Old Friday" originally on the first day of October 1804. Conveyed by Adam Markel to John Kusbaum, for five acres of land, more or less. Subject to a water right forever therein mentioned - the whole conveyed, by - Samuel Norris Trustee under a Decree of Frederick Court, sitting as a Court of Equity to Joshua Barnes by deed, bearing date the 20th day of October, 1851. lying in Frederick County Maryland.

State of Maryland Frederick County to wit: I do hereby certify - that at the request - of Peter Engel trustee of Joshua Barnes dec^d. I have surveyed the aforesaid parcels of lands, and reduced the whole into one entire survey, contained within the following metes and bounds viz. Beginning for the out-line, at a stone here to fore planted, at the Beginning of the deed from Adam Markel to John Kusbaum for 100 acres part of "Father's Gift" and running thence with & bounding on the first line thereof, allowing 2' for retrograde variation S. 17° : W. 89 ps. to a stone now planted at the end of 41 ps on the fourth line of $46\frac{1}{4}$ acres, and 21 square perches of Land part of the Resurvey on Smith's Lot" Conveyed by Gabriel Markel to John Kusbaum, then reversing said line, & bounding thereon, allowing $1\frac{3}{4}$ ' for retrograde variation to correspond with stones formerly planted, N. $65\frac{1}{2}$ ' W. 41 ps. to a stone, still reversing the lines of said deed, and bounding thereon allowing as aforesaid N. $69\frac{1}{4}$ ' West 22 ps. to a stone S. $66\frac{3}{4}$ ' W. 34 ps. to a stone S. $88\frac{1}{4}$ ' W. 14 ps. to a stone, at the Beginning of said deed, then reversing the given line thereof, and bounding thereon S. $11\frac{3}{4}$ ' W. 16 ps. to the middle of the public Road, leading from Liberty Town, to Batterman, still reversing the lines of said deed, allowing as before, S. 60° : E. $104\frac{1}{4}$ ps. S. 75° : E. 44 ps. to

a stone formerly planted N 26 1/2° E. 30 ps. to a stone formerly planted at the root of a black oak tree (now fallen and removed) at the end of the third line of the Deed from Adam Mackel to John Ausbaum aforesaid. then with bounding on the fourth line thereof, allowing 2' for retrograde variation S 66 1/4° E. 13 1/2 ps to a stone formerly planted at the Beginning of the Deed from Jacob Smith to Andrew Woman, then with and bounding on the first line thereof connecting the course to Correspond with stones heretofore planted N 1/2° W. 60 ps. to a stone formerly planted at the end of the 7th line of the Deed from Adam Mackel to Caspar Dvoilless, bounding bearing date the 20th day of November 1817. then reversing, and bounding on the lines thereof, allowing 2' for retrograde variation N 27 1/2° W. 44 ps. to a stone N 36° E. 16 1/4 ps. to a stone N 23° W. 26 ps. to a stone N 79° W. 24 1/4 ps. to a stone S 85 1/2° W. 19 1/2 ps. to a stone N 33 1/2° E. 16 1/4 ps. to a stone N 22° W. 26 ps. to a stone N 79° W. 24 1/4 ps. to a stone S 85 1/2° W. 19 1/2 ps. to the place of Beginning. Containing & now laid out for 149 aces. of land.

Surveyed, Calculated, and plotted the 9th day of December 1854.
D. W. Nail.

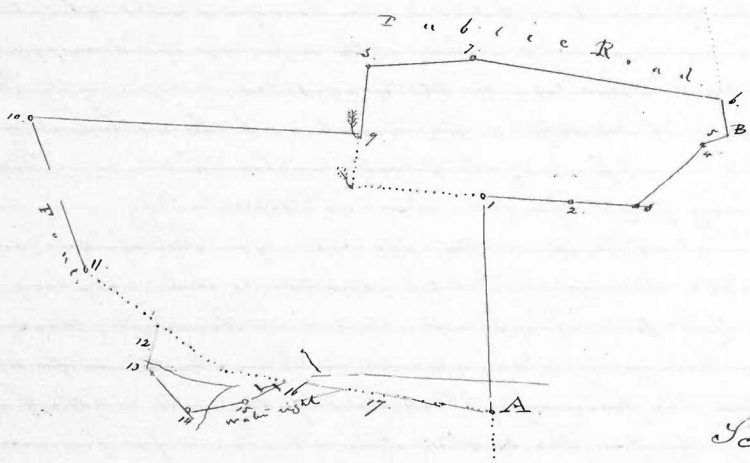

Scale of 50.