

Lots in the town of St of Rocks laid out for Smoot heirs being part of mine Baulk Farm.

John D. SMOOT Heirs

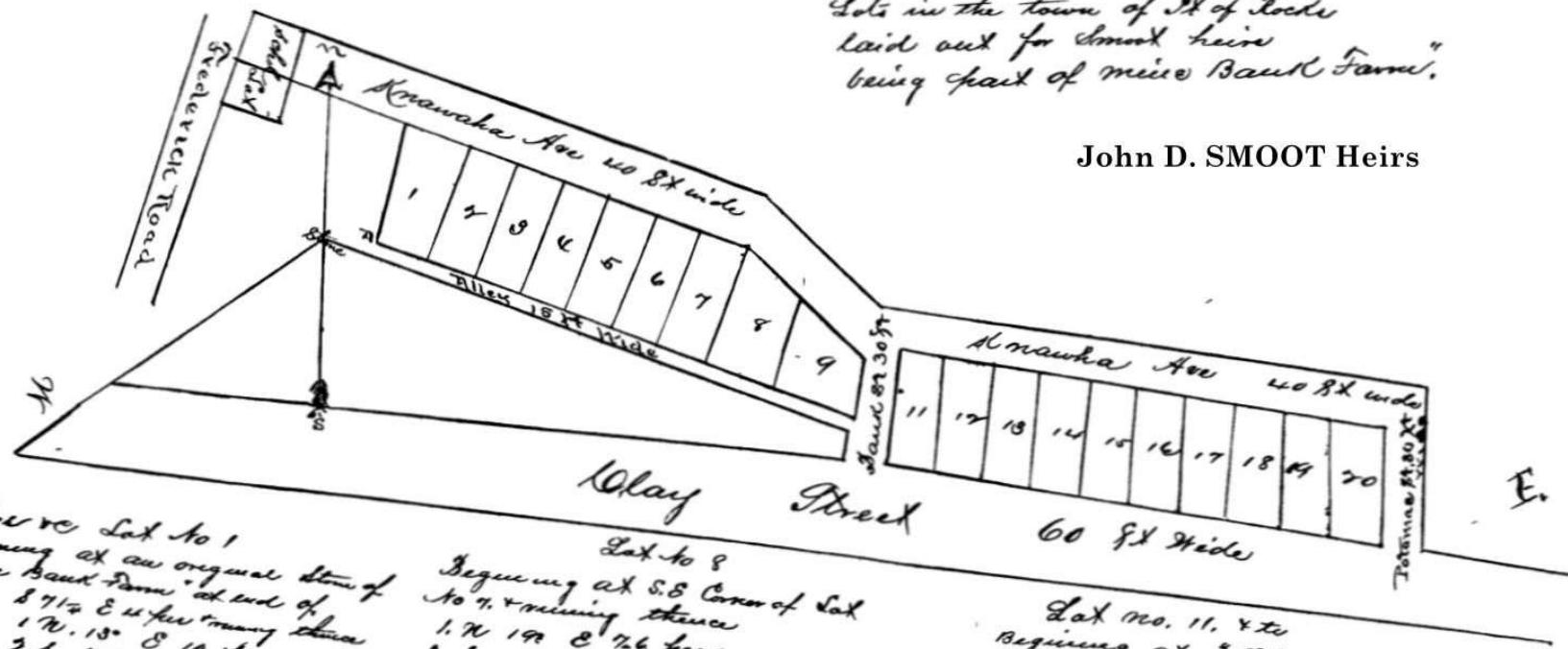

Beginning at Lat No 1
 Beginning at an original stone of
 mine Baulk Farm at end of
 8 7/16 E 16 feet corner thence
 1 N. 15° E 10 feet.
 2 S. 71 1/4° E 5 1/2 "
 3 S. 19° W 10 "
 4 N. 71 1/4° W 4 " to beginning
 containing 53 1/4 Sq Per

Lat No 2
 Beginning at S E Corner of Lat No 1
 1 N. 19° E 10 feet
 2 S. 71 1/4° E 4 "
 3 S. 19° W 10 "
 4 N. 71 1/4° E 4 " to beginning
 containing 40 Sq Perches

Lots No 2 to 7. inclusion have
 same bearings & lots quantity of
 land Sq: 40 Sq feet or 1/4 of an
 acre

Lat No 8
 Beginning at S.E. Corner of Lat
 No 7. & running thence
 1. N. 19° E 7.6 feet
 2 S. 46 1/4° E 6-8 "
 3 S. 19° W 7.7 "
 4 N. 71 1/4° W 6 " to beginning
 containing 26 5/14 Sq. Perches

Lat No 9.
 Beginning at S.E. Corner of Lat
 No 8 and running thence
 1 N. 19° E 9 feet
 2 S. 46 1/4° E 6-5 "
 3 S. 19° W 4 "
 4. N. 71 1/4° W. 6 " to beginning
 containing 35 1/4 Sq. feet

Lat No. 11. & to
 Beginning at S & W. Corner of Lat
 No 11 50 ft from center line of
 Klay Street & thence
 1 N. 17 1/2° E 10 feet.
 2 S. 82° E 4 "
 3 S. 17 1/4° W 10 "
 4 N. 82° W 4 " to beginning
 containing 40 Sq. feet

all lots from 11 to 20. inclusion
 have same bearings and same
 quantity of land Sq. 40. Sq feet
 or 1/4 of an acre

N. 7439 Equity. Filed Nov 27 1901
 Exhibit No. 3.

No. 7439, Equity

Description Lots
Addition to Pt. of Locke
C.B. Coblenz Sub.
July, 1903.

To Trustees Samuel Hines
of Mass. Bond St.

Description Lots Addition to Pt. of Locke.
Lot No. 9.

Beginning at the South East Corner or at the end of the 3rd line of Lot No. 8 and rising the 4th line of said Lot No. 8 as a base (said line being parallel to and 15 feet distant from the North line of the town of Locke as laid out and recorded in Liber No. P. No. 1, folio 737 one of the land records of Frederick County, and running thence with a deflection angle of $90\frac{1}{2}^{\circ}$ to the right 7 ft. to the end of 2nd line of Lot No. 8, thence along Kanawha ave. by a D. A. of $116\frac{1}{4}^{\circ}$ to the right, 7 ft. to intersection of Kanawha Avenue and Bank Street, thence with West margin of said St. by a D. A. of 65° to the right, 3 ft. to 15 feet alley thence with North Margin generally, by a D. A. of 88° to the right, 6 ft. to the beginning, containing in and about $39\frac{1}{2}$ sq. ft. of land.

Lot No. 11.

Beginning at the intersection of the East Side of Bank Street and the North Side of Clay Street, said point being 38 feet east of the South East Corner of Lot No. 124, described in a plat of Part of Locke, recorded in Liber No. P. No. 1, folio 737, one of the land records of Frederick County, and running thence with the East Margin of said Bank Street, and using the North line of Clay Street as base by a deflection angle of $101\frac{1}{2}^{\circ}$ to the right, 10 ft. to intersection of Bank Street and Kanawha Avenue thence with the South Margin of Kanawha ave. and by a D. A. of $78\frac{1}{2}^{\circ}$ to the right, 3 ft. to end of 1st line of Lot No. 12, thence with said line, and by a D. A. of $96\frac{1}{2}^{\circ}$ to the right, 10 ft. to Clay Street, thence with it, and by a D. A. of $83\frac{1}{2}^{\circ}$ to the right, 4 ft. to the beginning, containing 42 sq. ft. of land more or less.

Lot No. 12.

Beginning at the end of 3rd line of Lot

No. 7439, Equity.

No. 11. Said point being on the North Margin of Clay Street 115 ft. 4 inches from the South East Corner of Lot No. 124, as designated on a plat of Part of Locke, recorded in Liber No. P. No. 1, folio 737 one of the land records of Frederick County, and running thence with said 3rd line resumed using the North line of Clay Street as base by a deflection angle of $96\frac{1}{2}^{\circ}$ to the right, 10 ft. to Kanawha ave. thence with it by a D. A. of 84° to the right, 4 ft. to the end of 1st line of Lot No. 13, and with it, rev. by a D. A. of $96\frac{1}{2}^{\circ}$ to the right, 10 ft. to Clay Street thence with it, and by a D. A. of $83\frac{1}{2}^{\circ}$ to the right, 4 ft. to the beginning, containing in and about $1\frac{1}{2}$ acre of land.

Lot No. 13.

Beginning at the end of 3rd line of Lot No. 12, said point being 18 ft. 4 inches from the S.E. Corner of Lot No. 124, as same is located on a plat of Part of Locke recorded in Liber No. P. No. 1, folio 737, one of the land records of Frederick County, and running thence using the North Margin of Clay St. as base, with the 3rd line of Lot No. 12, rev. by a deflection angle of $96\frac{1}{2}^{\circ}$ to the right, 10 ft. to Kanawha ave. and with the South Margin of said Avenue and by a D. A. of $83\frac{1}{2}^{\circ}$ to the right, 4 ft. to the end of 1st line of Lot No. 14, thence said line rev. and by a D. A. of $96\frac{1}{2}^{\circ}$ to the right, 10 ft. to the North Margin of Clay Street thence with said Street by a D. A. of $83\frac{1}{2}^{\circ}$ to the right, 4 ft. to the beginning, containing in or about 40 sq. ft. of land.

Lots Nos 14, to 20, inclusive similar to description of Nos 12 + 13 given above description of Hines sold to Nichol being part of the Lloyd Trust land and part of Lot 125. Beginning on the North Margin of Clay Street at the South East Corner of Lot No. 124 as designated on a plat of Part of Locke, recorded in Liber No. P. No. 1, folio 737, one of the land records of Frederick County and running thence with the line of Lot No. 124 and using the North Margin of Clay Street as base, by a deflection angle of 90 degrees to the right - about 99 feet to an alley thence with South Margin of said alley and North Margin of Part of Bank by a D. A. of $99\frac{1}{2}^{\circ}$ to the right, 32 ft. to the West Margin of Bank Street, thence with West Margin of said Street and by a D. A. of

No. 7439, Equity

92° to the right, 90 feet to the North Margin of Clay Street thence with said St. and by a D. A. of $101\frac{1}{2}^{\circ}$ to the right, 8 feet to the beg. containing about 6 1/2 sq. ft. of land.